

Community-Based Preparedness

Make A Plan

Build A Kit

Be Prepared



Emergency Management

POLICE DEPARTMENT

UNIVERSITY OF COLORADO ANSCHUTZ MEDICAL CAMPUS

Email:

Emergencymgmt@cuanschutz

Background

The Campus

The University of Colorado Anschutz Medical Campus is the largest academic health center in the Rocky Mountain region at the forefront of transformative education, science, medicine and healthcare.

The 256-acre campus includes the University of Colorado health professional schools, multiple centers and institutes and two nationally ranked hospitals, UCHealth University of Colorado Hospital and Children's Hospital Colorado, with nearly 2.1 million patient visits each year.

All interconnected, these organizations collaboratively improve the quality of patient care they deliver, research they conduct and health professionals they train.



Emergency Management

POLICE DEPARTMENT

UNIVERSITY OF COLORADO ANSCHUTZ MEDICAL CAMPUS

Emergency Management

- Emergency planning and preparedness
- Campus preparedness & education
- Facilitation of training exercises
- Coordinate & collaborate with all campus partners and stakeholders to manage all emergencies
- Tracking and management of recovery effort



Director of Emergency
Management
Garrey (Grey) Martinez



Emergency Management
Program Manager
Alex Ottoni-Belval



Emergency Management

POLICE DEPARTMENT

UNIVERSITY OF COLORADO **ANSCHUTZ MEDICAL CAMPUS**

Preparedness Loop

Public Education Hazard
Vulnerability Assessment
Improved Infrastructure

Mitigation

Emergency Response
Plans Training & Exercises
Built-environment
Preparedness

Preparedness

Recovery

Economic Recovery Debris
and facility management
Reconstitution

Response

Life Safety Incident Stabilization
Property Preservation Evacuation,
Sheltering, Reunification
Mass Care



Mitigation

Hazard mitigation planning reduces loss of life and property by minimizing the impact of disasters. It begins with identifying natural, human-caused, or technological disaster risks and vulnerabilities that are common in the area. After identifying these risks, then developing long-term strategies for protecting people and property from similar events. Mitigation plans are key to breaking the cycle of disaster damage and reconstruction.

- Public Education
- Hazard Vulnerability Assessment
- Improved Infrastructure



Emergency Management

POLICE DEPARTMENT

UNIVERSITY OF COLORADO **ANSCHUTZ MEDICAL CAMPUS**

Mitigation Generator Power



Emergency Management

POLICE DEPARTMENT

UNIVERSITY OF COLORADO ANSCHUTZ MEDICAL CAMPUS

Mitigation

Classroom Security Project

RC1N, 1st Floor

ED1

ED2N

ED2S



Bleeding Control
Kits

AED



Podium-Mounted
Panic Buttons



Blue Strobe Lights



Wall-Mounted
Panic Buttons



Emergency Management

POLICE DEPARTMENT

UNIVERSITY OF COLORADO ANSCHUTZ MEDICAL CAMPUS

Emergency Management Campus Resources



Mitigation

Emergency Communications



Anschutz

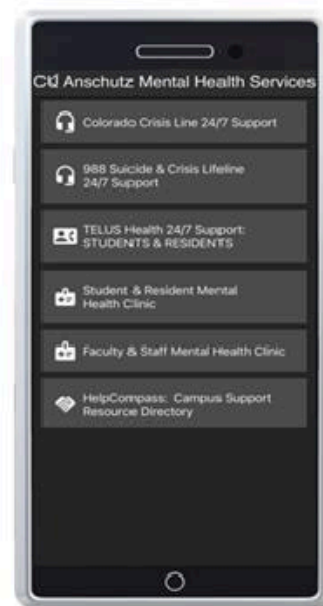
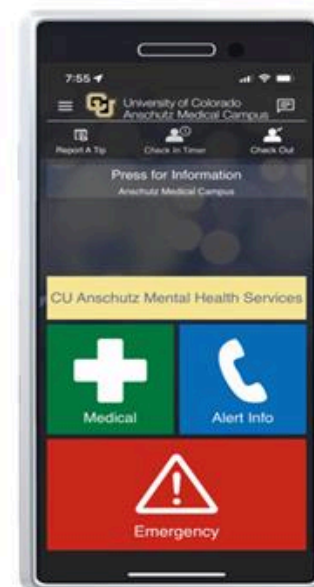

Emergency Management

POLICE DEPARTMENT

UNIVERSITY OF COLORADO ANSCHUTZ MEDICAL CAMPUS

Preparedness

Preparedness is defined by DHS/FEMA as "a continuous cycle of planning, organizing, training, equipping, exercising, evaluating, and taking corrective action in an effort to ensure effective coordination during incident response." This cycle is one element of a broader National Preparedness System to prevent, respond to, and recover from natural disasters, acts of terrorism, and other disasters.

- Emergency Response Plans
- Training & Exercises
- Built-environment Preparedness



Emergency Management

POLICE DEPARTMENT

UNIVERSITY OF COLORADO ANSCHUTZ MEDICAL CAMPUS

Preparedness

Emergency Response Plans

The Emergency Response Guide is a 1-page flyer that is posted throughout the facilities that outlines scenario- specific actions that may be critical to ensure the safety of tenants and or others visiting the facility.

The flyer is an provides abbreviated response protocols directly from your Building-Wide Emergency Response Plan.

University of Colorado
Anschutz Medical Campus

Scan QR Code
For Spanish

EMERGENCY

SEVERE WEATHER
Calmly Seek Shelter

- Move to an interior room on the lowest level.
- Stay away from windows and exterior doors.
- Follow directives from emergency personnel.
- After the storm passes, stay clear of damaged areas. Be aware of hazards.

FIRE
Follow A-RACE

- **ACTIVE:** Pull fire alarm.
- **RESCUE:** If safe, assist other personnel out of the area.
- **ALERT:** From a safe location, Call 303-724-4444.
- **CONFINE:** Close doors as you exit.
- **EXTINGUISH:** If safe, extinguish the fire.
- **EVACUATE:** Follow exits.

ACTIVE HARMER
Run, Hide, Fight

- **Run:** Attempt to evacuate as far as possible on foot.
- **Hide:** Seek a hiding place out of the harmer's view.
- **Fight:** As a last resort, attempt to incapacitate the active harmer.
- Follow directive from emergency personnel.

MEDICAL EMERGENCY
Take Action

- Call 303-724-4444.
- Provide location, nature of illness/injury, the current condition of the victim.
- Do not move the victim unless in immediate danger.
- If trained, begin first aid/CPR/AED as needed.
- Send someone to meet emergency responders.

EMERGENCY

Call CU Anschutz Police
303-724-4444
Or
911 from a landline
Or Use
 SafeZone

BOMB THREAT
Remain Calm

- Call 303-724-4444 from a land line phone.
- Follow directives from emergency personnel.
- If evacuating, assemble at designated rally points.
- Restrict unnecessary cellphone or radio usage.
- Avoid area until authorized by emergency personnel.

SUSPICIOUS OBJECTS/ACTIVITY
See Something Say Something

- Trust your instincts and err on the side of caution.
- Call 303-724-4444.
- Report objects out of the ordinary or present a significant concern.
- Report persons behaving strangely, displaying signs of distress, or erratic behavior.
- Report sexual misconduct.

HAZARDOUS MATERIALS
Stay Back

- Evacuate the area, closing doors behind you, and assemble at designated rally points.
- Call 303-724-4444.
- Provide location and description of hazard and known and any injuries.
- If non-life-threatening, call CU Anschutz Environmental Health & Safety 303-724-0345.

ACCESS & FUNCTIONAL NEEDS
Think Inclusion

- Support and use a "buddy system" to assist people with mobility or functional needs.
- If you are unable to assist, notify emergency responders of the location and the number of persons who need help in the area.

Revised 2024

Preparedness

Emergency Response Plans

The Building-Wide Emergency Response Plan contains information that may be critical to ensure the safety of tenants and or others visiting the facility.

The document contains scenario-specific response protocols and should be adopted by all tenants of the facility.

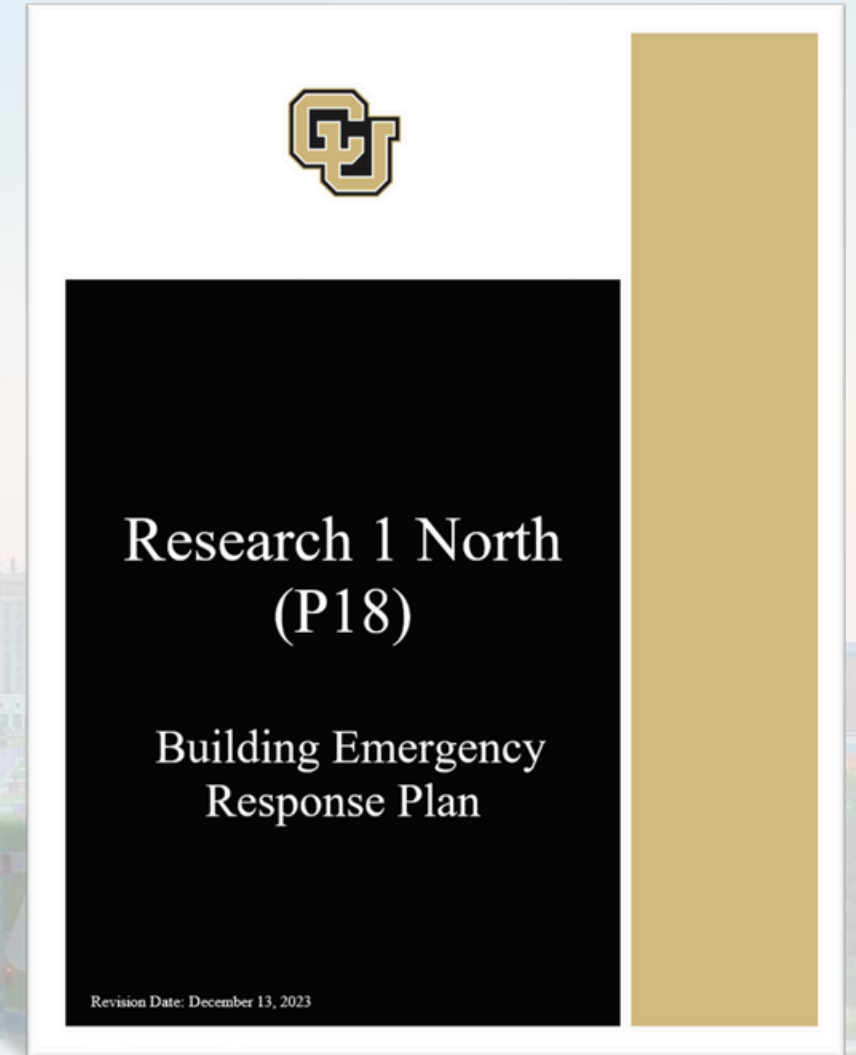

Emergency Management

POLICE DEPARTMENT

UNIVERSITY OF COLORADO **ANSCHUTZ MEDICAL CAMPUS**

Preparedness

Emergency Response Plans

The Comprehensive Emergency Management Plan (CEMP), establishes the basis for providing emergency response resources and assistance to the campus community if impacted by emergency or disasters.

The CEMP covers all four phases of emergency management: mitigation, preparedness, response, and recovery.

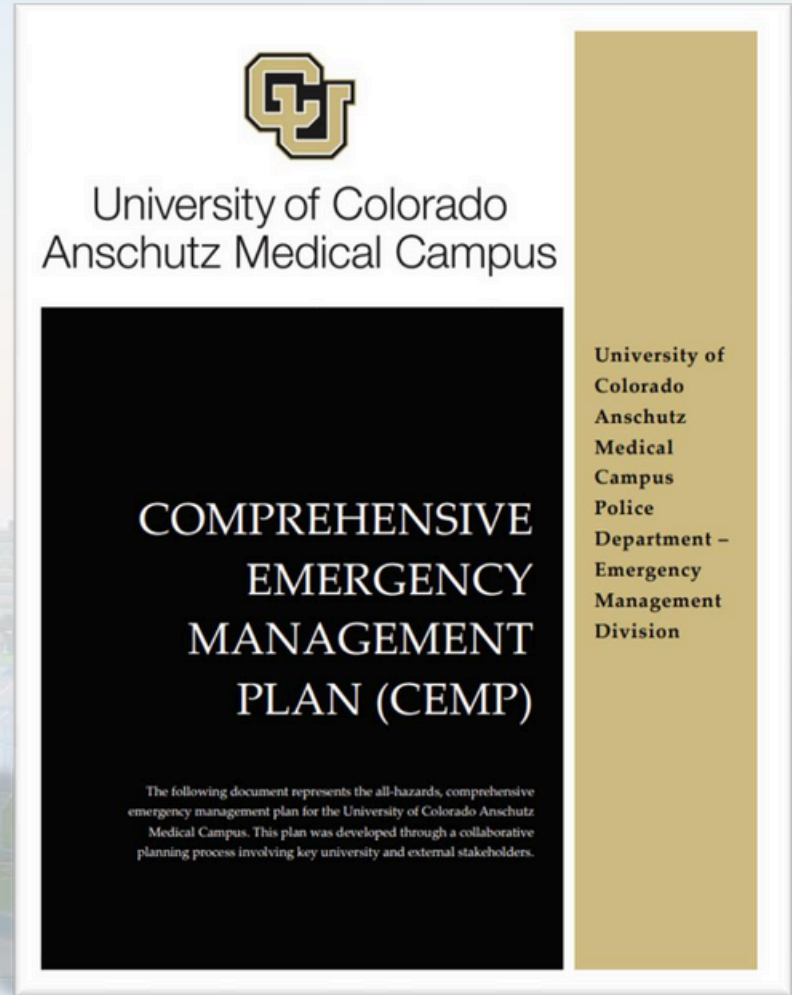

Emergency Management

POLICE DEPARTMENT

UNIVERSITY OF COLORADO ANSCHUTZ MEDICAL CAMPUS

Preparedness

Emergency Response Plans

What is COOP?

An effort within individual executive departments and agencies to ensure that Primary Mission Essential Functions (PMEFs) continue to be performed during a wide range of emergencies, including localized acts of nature, accidents and technological or attack-related emergencies (Inclement Weather).

Why is it Important?

Planning fosters recovery and survival in and after emergency situations. COOP establishes processes and procedures that allow for the continuation of essential functions when you can't be in your normal workspace, or a significant portion of your staff is absent (COVID-19).



Preparedness Training & Exercises

Severe Weather Preparedness Training:

- Preventing Targeted Violence:
- Build A Kit Training:
- COOP 101 Training:
- Stop The Bleed® Training:
- Skillsoft – Active Harmer Preparedness:
- R.A.D. Rape Aggression Defense Systems Training:

Training & Events Calendar

Campus resiliency starts with a preparedness mindset. The Emergency Management Division regularly hosts a variety of courses and trainings, that provide attendees with the skills, resources, and knowledge to adapt and respond to emergency situations.

The training and events calendar is updated regularly. Register today by clicking on any of the upcoming training events.

If you are interested in hosting a training for your school, department, or college, contact us directly at: emergencymgmt@cuanschutz.edu.



CU Anschutz Campus Safety Information Session

The CU Anschutz Campus Safety Information Session will take place in the AHSB atrium on Wednesday, January 17, 2024...

Wednesday, January 17 | 11:30 am

[Anschutz Health Sciences Building \(P12\)](#)

Add to Calendar



Severe Weather Preparedness

Have you ever wondered what to do during severe weather? The CU Anschutz Emergency Management Division welcomes you to attend...

Thursday, January 18 | 12:00 pm

Add to Calendar

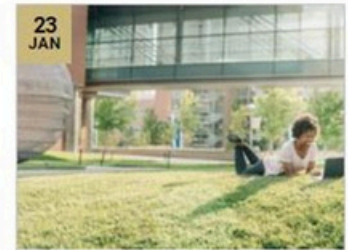

Build-a-Kit

Natural, human-caused, and technological disasters can occur at any time. Having a plan and an emergency disaster kit increases...

Tuesday, January 23 | 12:00 pm

[Campus Services Building 116](#)

Add to Calendar



Emergency Management

POLICE DEPARTMENT

UNIVERSITY OF COLORADO ANSCHUTZ MEDICAL CAMPUS

Preparedness Training & Exercises



Discussion-Based Exercises



Tabletop Exercises

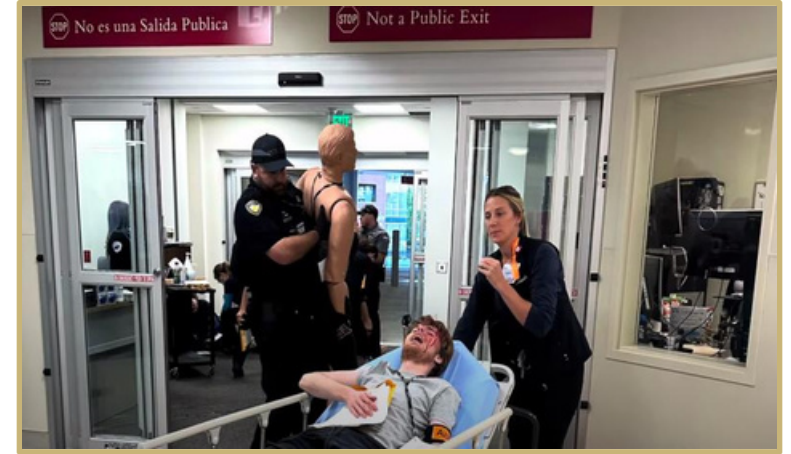

Full Scale Exercises



Emergency Management

POLICE DEPARTMENT

UNIVERSITY OF COLORADO **ANSCHUTZ MEDICAL CAMPUS**

Preparedness

Built Environment Preparedness

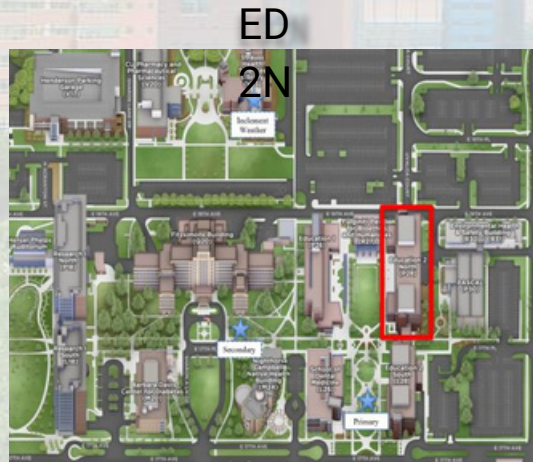
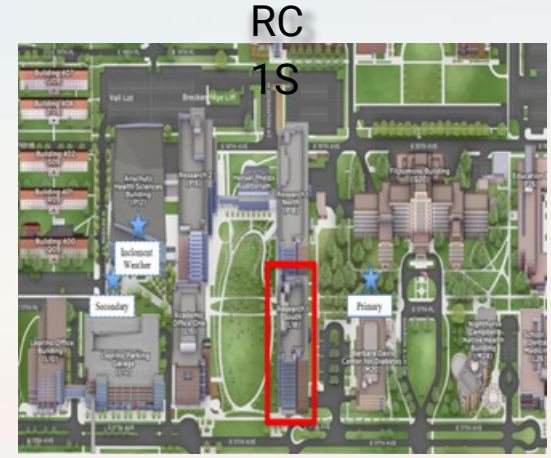
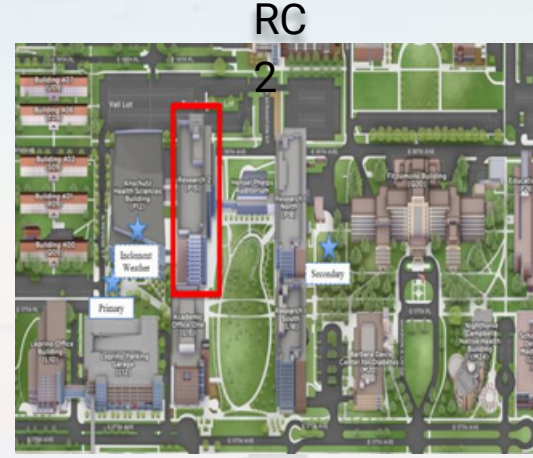

Emergency Management

POLICE DEPARTMENT

UNIVERSITY OF COLORADO ANSCHUTZ MEDICAL CAMPUS

Response

Response activities that address the short-term, direct effects of an incident. Response includes immediate actions to save lives, protect property, and meet basic human needs. Response also includes the execution of emergency operations plans and of mitigation activities designed to limit the loss of life, personal injury, property damage, and other unfavorable outcomes.

- Life Safety
- Incident Stabilization
- Property Preservation
- Evacuation, Sheltering, Reunification
- Mass Care



Emergency Management

POLICE DEPARTMENT

UNIVERSITY OF COLORADO ANSCHUTZ MEDICAL CAMPUS

Response

Emergency Operations

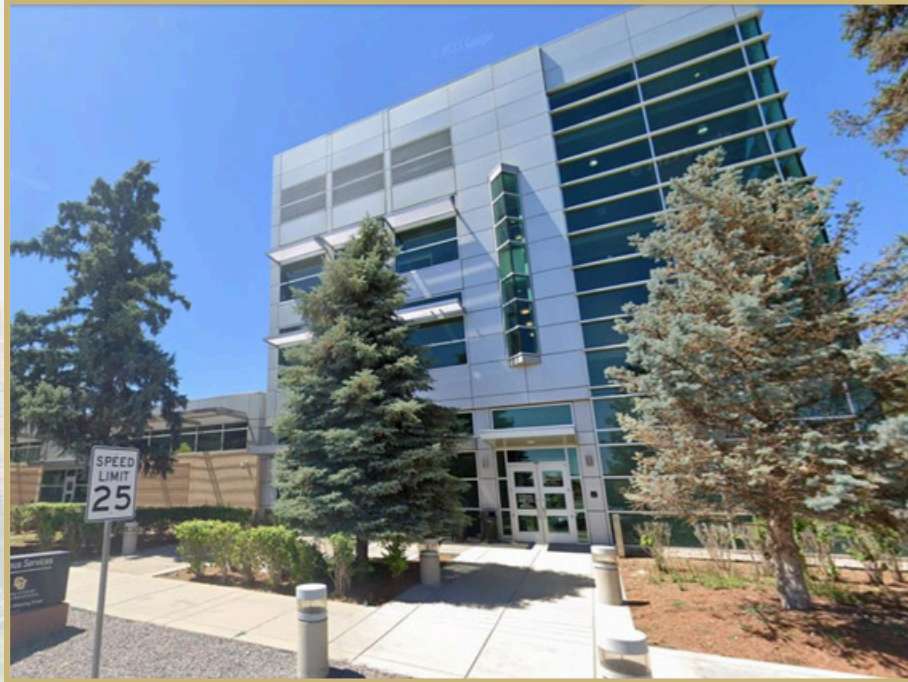

Campus Services Building T36



Emergency Operations Center



Emergency Management

POLICE DEPARTMENT

UNIVERSITY OF COLORADO **ANSCHUTZ MEDICAL CAMPUS**

Response

Emergency Response Team

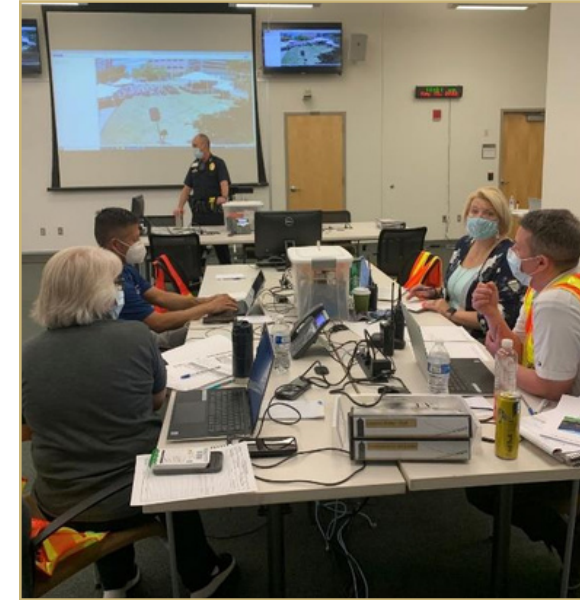
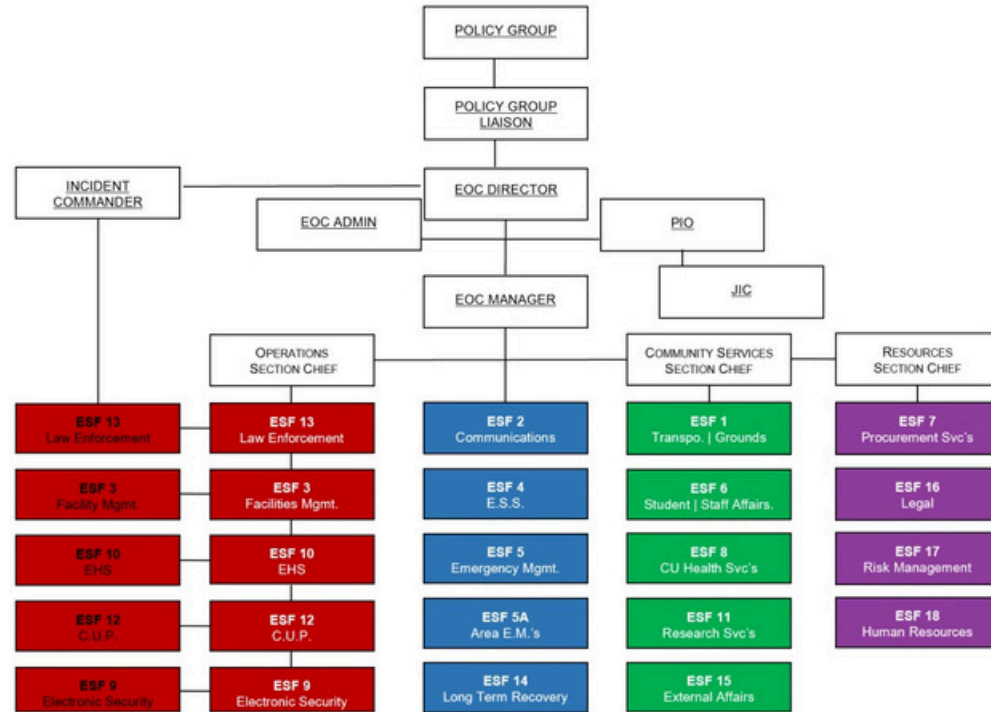

Emergency Management

POLICE DEPARTMENT

UNIVERSITY OF COLORADO ANSCHUTZ MEDICAL CAMPUS

Response

Access Control Cabinets

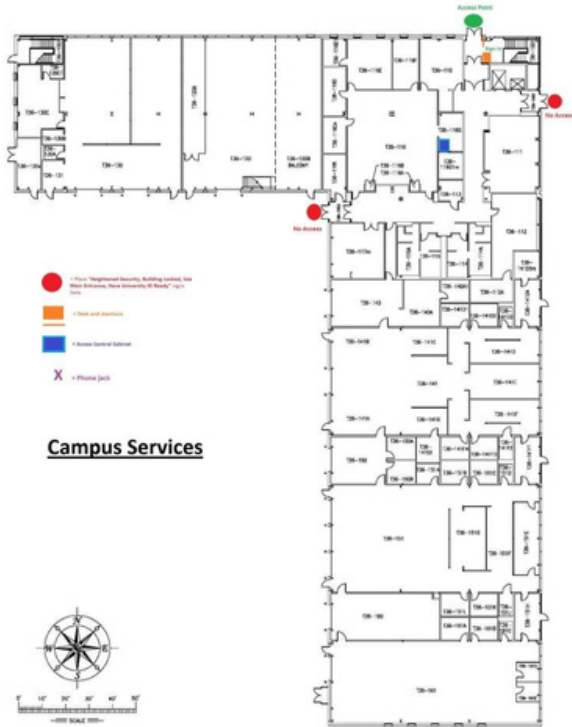

HEIGHTENED SECURITY

IDENTIFICATION
REQUIRED
FOR ENTRY



Emergency Management

POLICE DEPARTMENT

UNIVERSITY OF COLORADO ANSCHUTZ MEDICAL CAMPUS



Add this number to your cellphone

303-724-4444

Police Dispatch

- Emergencies
- Non-Emergencies
- Safe Ride
- Door Openings
- Motorist Assistance
- After Hours Gates

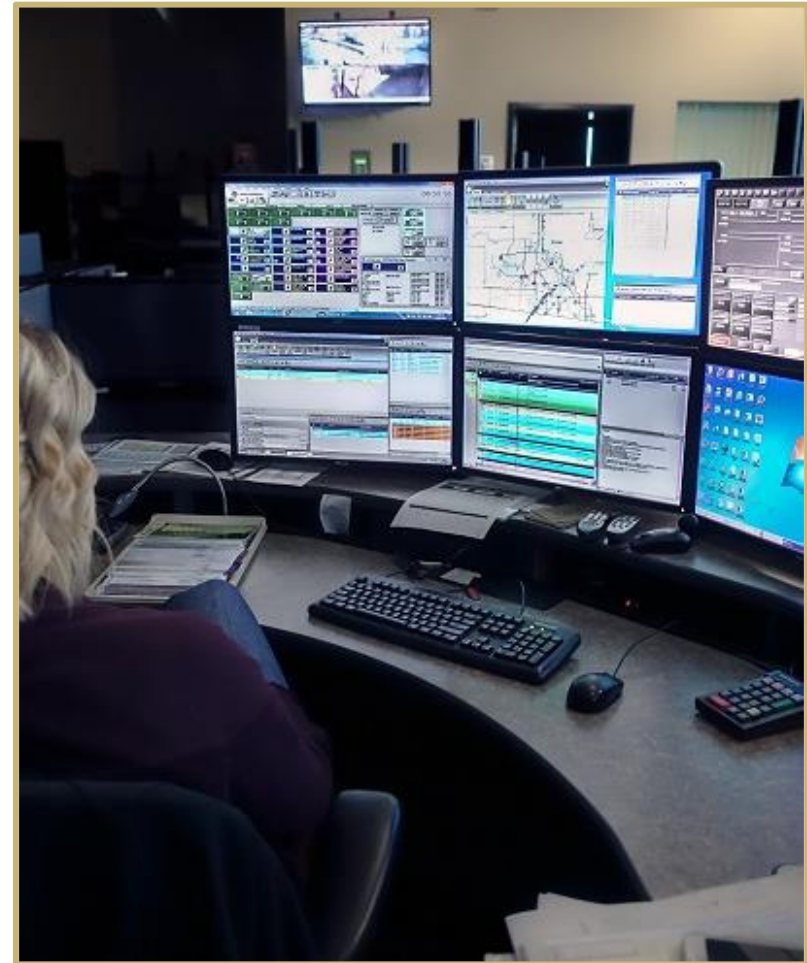

Emergency Management

POLICE DEPARTMENT

UNIVERSITY OF COLORADO **ANSCHUTZ MEDICAL CAMPUS**

Recovery

Recovery encompasses both short-term and long-term efforts for the rebuilding and revitalization of affected communities.

- Economic Recovery
- Debris and facility management
- Reconstitution



Emergency Management

POLICE DEPARTMENT

UNIVERSITY OF COLORADO **ANSCHUTZ MEDICAL CAMPUS**

Recovery

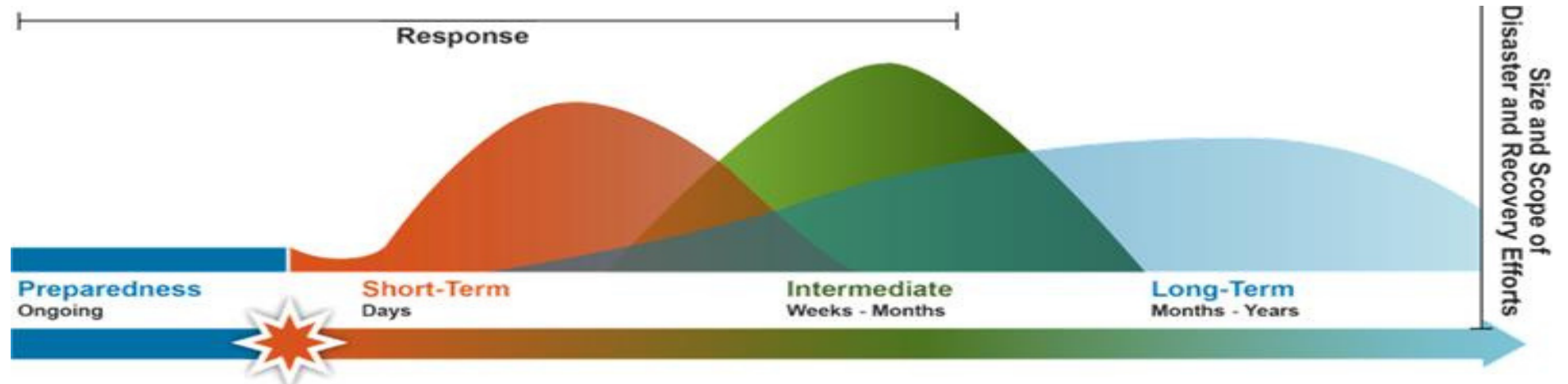
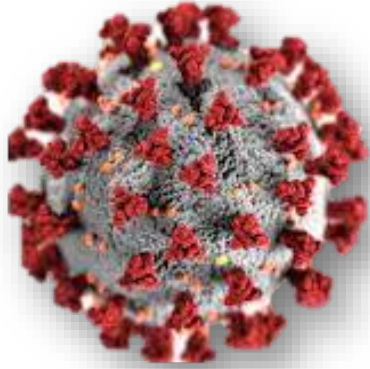

Emergency Management

POLICE DEPARTMENT

UNIVERSITY OF COLORADO ANSCHUTZ MEDICAL CAMPUS

Mitigation

Preparedness

Response

Recovery

EMERGENCY MANAGEMENT

University of Colorado Anschutz Medical
Campus emergencymgmt@cuanschutz.edu



Emergency Management
Campus Resources



Emergency Management
Training & Events



CU Anschutz
SAFE App



Emergency Response
Guide



Emergency Management

POLICE DEPARTMENT

UNIVERSITY OF COLORADO ANSCHUTZ MEDICAL CAMPUS

THANK YOU



Emergency Management

POLICE DEPARTMENT

UNIVERSITY OF COLORADO **ANSCHUTZ MEDICAL CAMPUS**