

# Anschutz HSB - Elliman Conference Center

*FLOOR 2, ROOM P12-2002*

**Classroom Occupancy: 24**

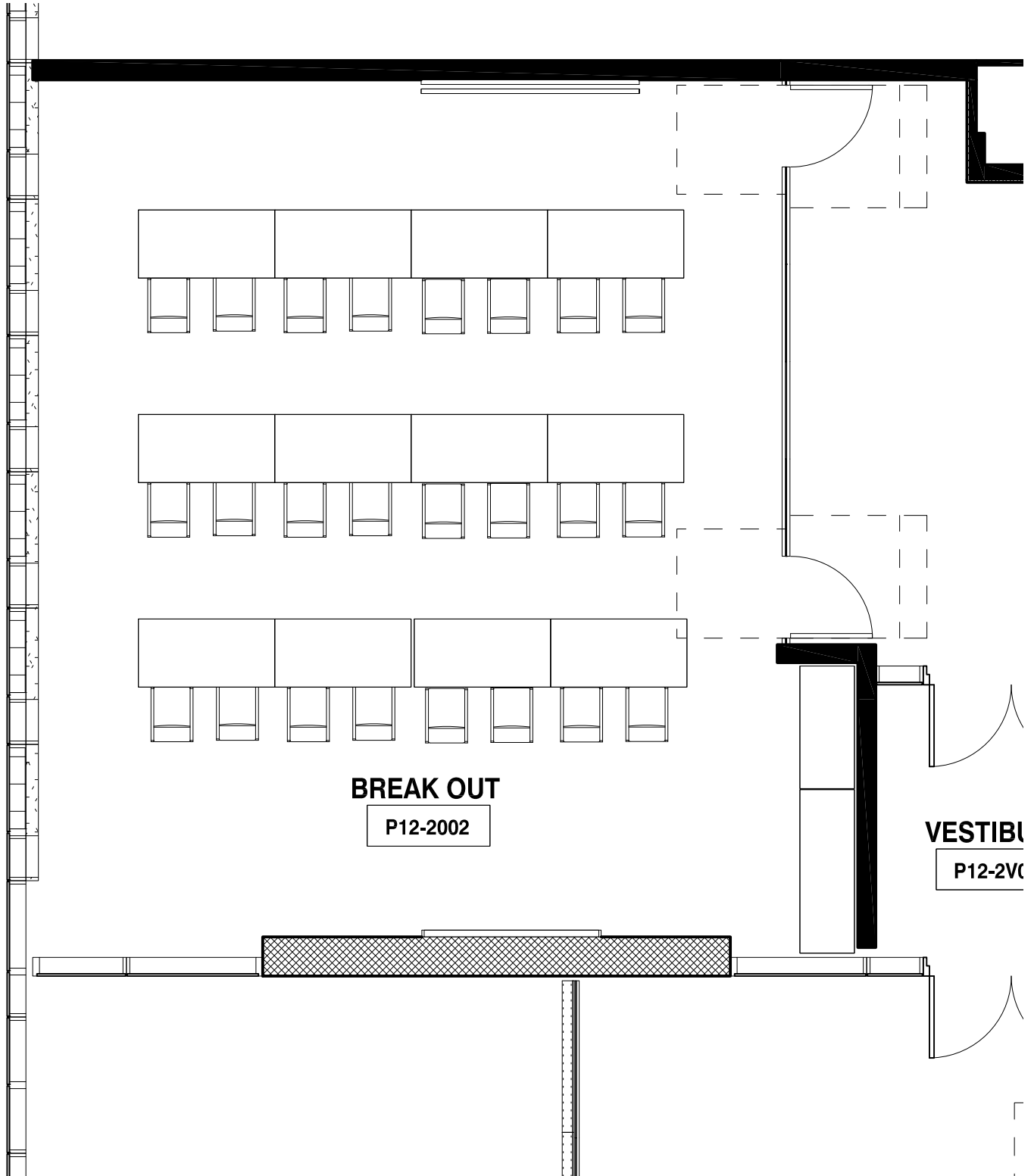

SCALE: 3/16" = 1'-0"



# Anschutz HSB - Elliman Conference Center

*FLOOR 2, ROOM P12-2002*

**Lecture Occupancy: 48**

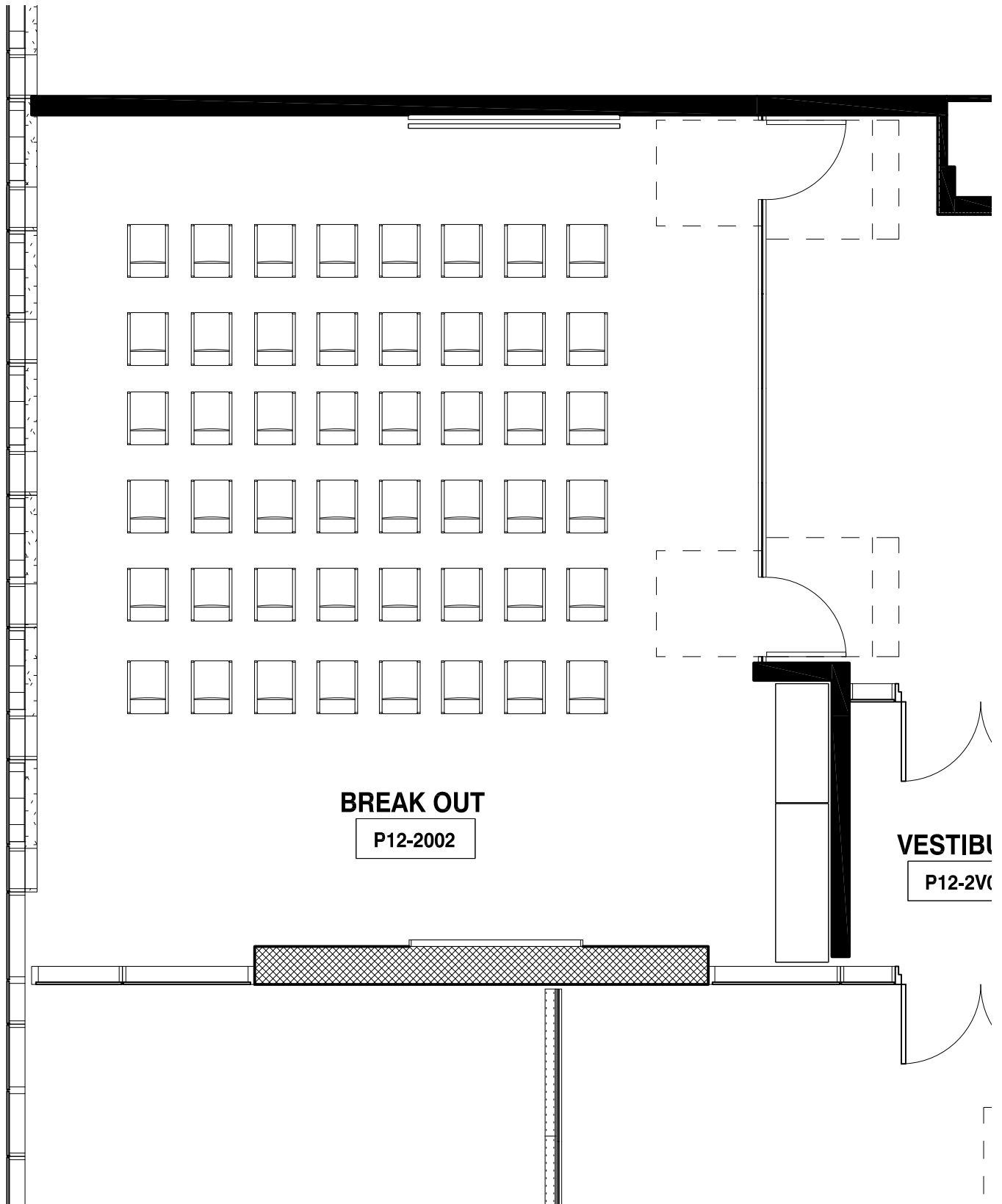

**BREAK OUT**

P12-2002

**VESTIBULE**

P12-2002

SCALE: 3/16" = 1'-0"



NORTH

# Anschutz HSB - Elliman Conference Center

*FLOOR 2, ROOM P12-2002*

**Event Occupancy - 32**

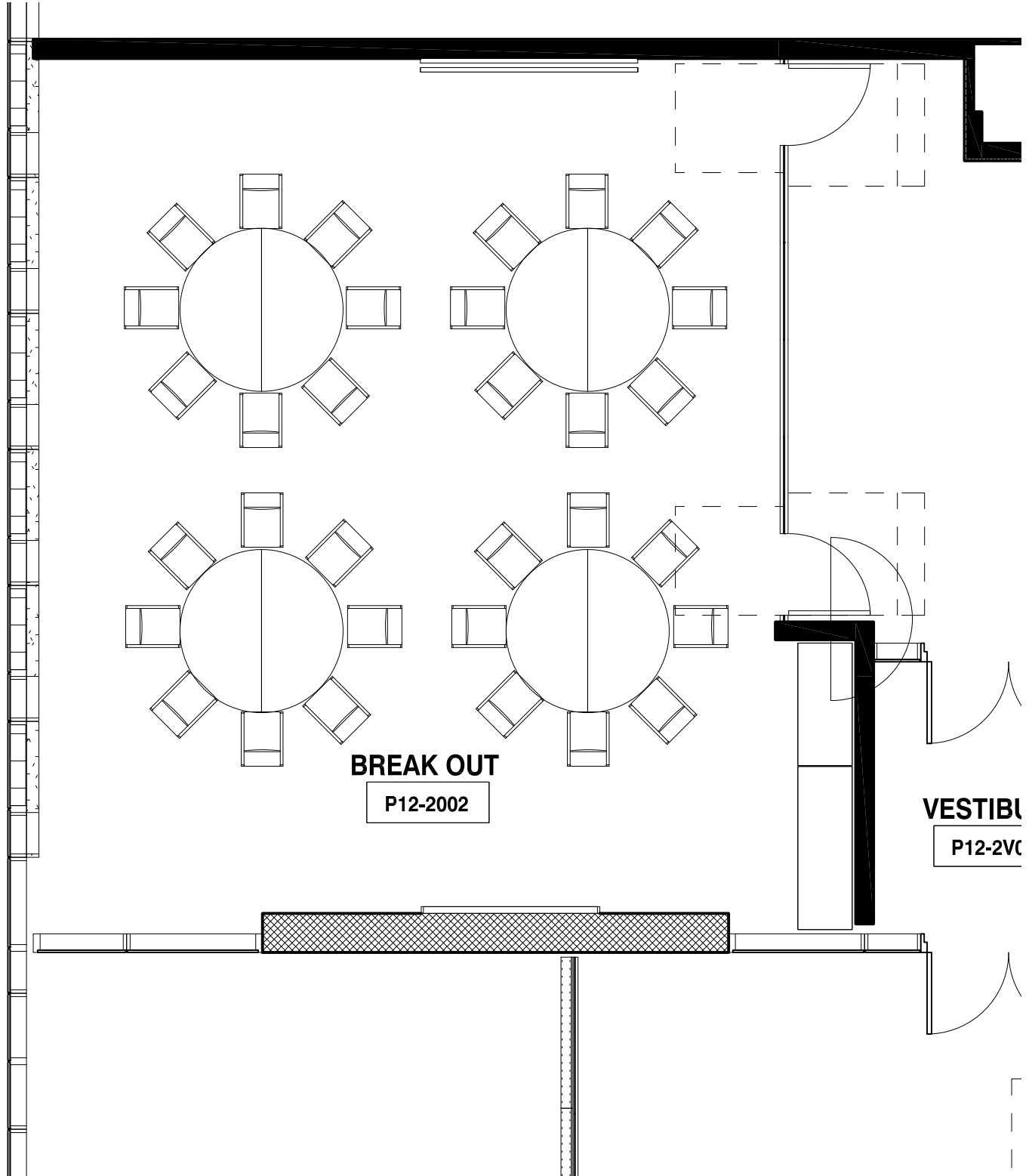

SCALE: 3/16" = 1'-0"

 NORTH